

Section 51 Rear Suspension: Rear Spring, Differential, Crossmember, rear shocks, Trail Arm, u-joints, driveshafts, half shafts, shims

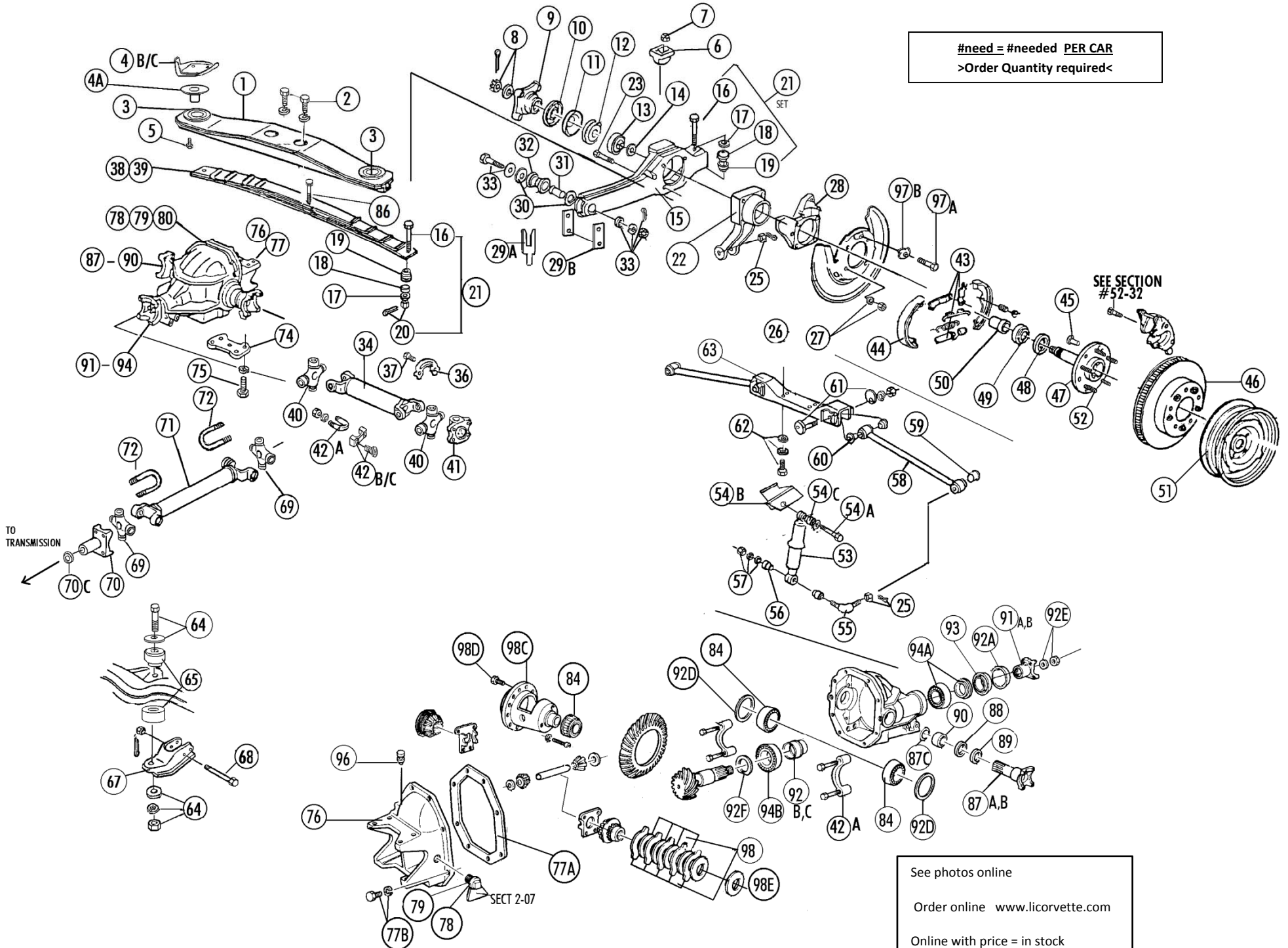

# Section 51 Rear Suspension: Rear Spring, Differential, Crossmember, Shocks, Trailing Arms ...

Part#	Name	Year	#Need/Car	Price
51-01	x Cross Member With Cushions (Diff Carrier) x	63-7	1	\$ n/a
51-02	Diff Carrier Bolts And Lw (4 Ea)(O)	63-7	1 SET	4.00 Set
51-03	Cushion (Diff Carrier)	63-7	2	66.00 Each
51-04A	Cushion Steel Sombrero (weld To Bracket)	63-7	2	38.00 Each
51-04B	Sombrero Bracket (weld To Frame)(LH)	63-7E	1	45.00
51-04C	Sombrero Bracket (weld To Frame)(RH)	63-7E	1	45.00
51-04D	Sombrero Bracket (weld To Frame)(LH)	67L-	1	45.00
51-04E	Sombrero Bracket (weld To Frame)(RH)	67L	1	45.00
51-05	Cushion Bolts & Lw (2 Ea)	63-7	1 PR	2.00 Pair
51-06A	Bumper (Rear Torque Arm)(until April 64)w brackt	63-4E	2	30.00 Each
51-06B	Bumper (rear torque arm) (with tab) (1)	64L-7	2	12.50 Each
51-07A	Bumper Bolts, Nuts Set	63-4	1 SET	2.75 Set
51-07B	Bumper Nuts (pr)	64-7	1 PR	0.50 Pair
51-08	Spindle Nut, Washer, Cotter Pin (2 Ea)	63-7	1 SET	18.00 Set
51-09	Spindle Flange & Deflector	63-7	2	79.00 Each
51-10	Spindle Flange Deflector	63-7	2	3.50 Each
51-11	Spindle Flange Shield	63-7	2	5.00 Each
51-12	Inner Rear Wheel Bearing Seal	63-7	2	15.00 Each
51-13	Inner Rear Bearing & Race (Delco)	63-7	2	44.00 Each
51-14	<b>Rear Spindle Shim Kit (9 Thicknesses)</b>	63-7	1 SET	30.00 Set
51-15A	X Trailing Arm (LH) 65-67 (not selling) slow item	65-7	1	n/a
51-15B	X Trailing Arm (RH) 65-67	65-7	1	n/a
51-15CD	X Trailing Arm 63-64 PAIR (not selling) slow item.	63-4	1	DISCONT.
51-16	Rear Spring End Bolt (black)	63-7	2	10.00 Each
51-17	Spring Bolt Flat Washer	63-7	4	2.50 Each
51-18	Rear Spring Rubber Cushion (1)	63-7	4	2.75 Each
51-19A	Spring Cushion Retainer (thinner)	63-6	4	3.75 Each
51-19B	Spring Cushion Retainer (thicker)	67	4	3.00 Each
51-20	Spring End Nut And Cotter Pin (2 +2)	63-7	1	1.50 Set
51-21A	<b>Rear Spring End Hardware (#16-20) with 4 #19A)</b>	63-6	1	48.00 Set
51-21B	<b>Rear Spring End Hardware (#16-20)(with 4 #19b)</b>	67	1 SET	48.00 Set
	(2)#16,(4)#17,(4)#18,(4)#19,(2)#20			
51-22A	<b>Spindle Bearing Housing (LH) (New) discontinued</b>	63-7	1	X
51-22B	Spindle Bearing Housing (RH) (New) discontinued	63-7	1	X
51-23A	Spindle Housing Studs (1) (2-1/4"	63-4	8	7.00 Each
51-23B	Spindle Housing Studs (1) (2-7/8"	65-7	8	2.50 Each
51-24	Seal & Bearing Kit (=1 Side)(51-12,13,48,49)	63-7	2 SET	\$ 95.00 Set
51-25	Shock Bkt/strut Arm Nuts And Cp (2 Ea)	63-7	1 SET	3.25 Set
51-26A1	<b>Parking Brake Plate LH (Gold) GM LEFT # 3864067 STAMPED ITM/not DelcoM 65-82 30.00</b>			
51-26	Parking Brake Plates PAIR (Correct Gold Color) repro 1 PAIR < 65-82	65-82	1	\$ 80.00
51-26B	<b>Parking Brake Plate (Correct Gold Color)(RH) 1 EXTRA</b>	65-7	1	\$ 45.00
	(correct Zinc Dichromate Gold Finish) With #logo fits 65-82 REPRO			
51-27	Nuts And Lw (for Stud #23)(8 Ea)	63-7	1 SET	3.25 Set
51-28A	Brake Flange Rear Bracket (LH)	65-7	1	75.00 Each
51-28B	Brake Flange Rear Bracket (R H)	65-7	1	75.00 Each
51-29A	Trailing Arm Shim Set (forked) (20 Shims)	63	1 SET	59.00 Set
	STEEL (FORKED SHAPE) STEEL/PLATED			
51-29B	<b>Trailing Arm Shim Set (both Sides) (20 Shims)(2 holes)</b>	64-7	1 SET	59.00 Set
	STEEL (2 HOLES) STEEL/PLATED			
51-30	Plate (trailing Arm Bushing)(s.s.) (1)	63-7	4	2.00 Each
51-31	Retainer Tube (1)(Trailing Arm Bushing)(s.s.)	63-7	2	6.75 Each
51-32	Bushing (trailing Arm)	63-7	4	10.00 Each
51-33A	Trailing Arm Pivot Bolts,washers Nut Set	63E	1 SET	9.00 Set
	63 Early = Thru March 63 ... After Use 33b			
51-33B	Trailing Arm Pivot Bolts,nut,lw,fw,cp	64-7	1 SET	10.00 Set
51-33C	Trailing Arm Bushing & Hardware Set (51-30,31,32,33A 33A)	63E	1 SET	53.00 Set
51-33D	Trailing Arm Bushing & Hardware Set (51-30,31,32,33B)	64-7	1 SET	58.00 Set
51-34	<b>Rear Axle Half Shaft,u-joints,flange (2-1/2") (1)</b>	63-7	2	195.00 Each
51-36A	French Lock (rear Axle)(4 Pc) STEEL	63-4	1 SET	19.00 Set
51-36B	French Lock (rear Axle)(4 Pc) STEEL	65-7	1 SET	10.00 Set
51-37	<b>Axle Flange Bolts (8 Pc)</b>	63-7	1 SET	12.00 Set
X 51-38A	<b>9 Leaf Spring (Standard) x ) sold out x no more</b>	63-7	1	n/a discount.
X 51-38B	<b>x 7 Leaf Spring (Heavy Duty) sold out x no more</b>	63-7	1	n/a
51-39	Spring Liner (each) (uses 7std Or 5 HD)	63-7	5-7	\$ 7.75 Each
51-40	Axle Universal Joint (no Zerks)	63-7	4	\$ 35.00 Each
51-40B	Axle Universal Joint With Zerks(grease Fitting)	63-7	4	30.00 Each
51-41	Axle Universal Joint Flange (1)	63-7	2	49.00 Each
51-42A	Diff U-bolt, Nut & Lw (327 All; 396/427 No Posi)	63-7	2 PR	7.00 Pair
51-42B	Diff Universal Joint Caps (396/427 Posi)	65-7	4	35.00 Each
51-42C	U-joint Cap Bolts & Lw (396/427 Posi)(8 Ea)	65-7	1 SET	10.00 Set
51-43	Parking Brake Kit S.S. (see Sect 52-40)			
51-44	Parking Brake Shoes S.S. (see Sect 52-41)			
51-45	Rivets- Rear Rotor To Spindle (10 Pc)	65-7	1 SET	7.50 Set
51-46	<b>Rear Wheel Brake Rotor</b>	65-7	2	75.00 Each
51-47A	<b>Rear Spindle (Drum Brakes) x</b>	63-4	2	\$ n/a
51-47B	<b>Rear Spindle (Disc Brakes)</b>	65-7	2	\$169.00 Each

**#need =**  
**#needed**  
**PER CAR**  
**>Order**  
**Qty<**

Part#	Name	Year	#Need/Car	Price
51-48	Outer Rear Wheel Bearing Seal	63-7	2	\$ 18.00 Each
51-49	Outer Rear Wheel Bearing Asm	63-7	2	\$ 40.00 Each
51-50	Wheel Bearing Spacer	63-7	2	15.00 Each
51-51, 52	Wheels (see Sect 46) AND STUDS see sect (see Sect 49-53a & 53b)			
51-53A	Rear Shock Absorber (standard) (use 51-53AG)	63-7	2	N/A
51-53AG	<b>Rear Shock (standard gas shock)(Delco Replacement)</b>	63-7	2	\$ 48.00 Each
51-53B	Rear Shock (Heavy Duty)(replacement) x	63-7	2	N/A
51-53C	Heavy Duty Rear Shocks (2)(Heavy Cap/washer,not	64-7	1 pr	\$ 400.00 PAIR
51-53C3	Heavy Duty Rear Shocks(2)(With Correct Cap,no#s)	63	1 pr	400.00 PAIR
	* NO #S) (64-67 gray, 63 black)			
51-54A	Rear Shock Upper Bolts, Nuts & Lw (2 Ea)(L5 Hdmk)	63-7	1 SET	9.00 Set
51-54B	Rear Shock Upper Bracket (weld To Frame)	63-7	2	14.00 Each
51-54C	Grommet & Tube- Rear Shock Upper (1 Car Set)	63-7	1 SET	22.00 Set
51-55A	Rear Lower Shock Bracket (LH)	63-7	1	45.00
51-55B	Rear Lower Shock Bracket (RH)	63-7	1	45.00
51-56	Grommets- Shock Absorber (set Of 4)(lower)	63-7	SET	20.00 Set
51-57	Lower Shock Nuts, Lw & Retainers (2 Ea)	63-7	1 SET	7.00 Set
51-58A	<b>Strut Arm With Correct Small Head &amp; Bushings</b>	63-7	2	49.00 Each
51-59A	x Rear Strut Arm Bushing (for Orig Strut)(1-1/4")	DISCONTIND	4	N/A
51-60	Strut Bushing Cap (1)	63-7	4	2.50 Each
51-61A	X Cam Asm, Cam, Nut & Lw 1963 -- use B 64-67	63	2	n/a
51-61B	Cam Asm, Cam, Nut & Lw	64-7	2	28.00 Each
51-62	Strut Arm Bracket Bolt, Lw, Fw (4 Ea)(Repl)	63-7	1 SET	4.50 Set
51-63A	Strut Arm Bracket (used) X - not avail.	63	1	N/A
51-63B	Strut Arm Bracket (used) x not avail.	64-7	1	N/A
51-63C	X Weld On Plates For 63 Strut Arm Bracket	63	1 PR	N/A
51-64	Diff Front Bolt, Washers, Lw & Nut (repl Bolt)	63-7	1	5.00
51-65	<b>Mounting Cushions For Differential (pr)</b>	63-7	1 PR	18.00 Pair
51-67	Diff Mounting Bracket (used)(give Year)	63-7	1	N/A
51-68A	Diff Front Bracket Bolts,Nut,Lws Set(1Lng+2shrt)	63-4	1 SET	9.00 Set
51-68B	Diff Front Bracket Bolts, Nuts,Lw,Cp Set(2long)	65-7	1 SET	12.00Set
51-69A	<b>Drive Shaft Universal Joint (with Zerks)</b>	63-7	2	20.00 Each
51-69B	Drive Shaft Universal Joints (no Zerks)	63-7	2	30.00 Each
51-70A	xTrans Rear Yoke 63-64 (Coarse Spline/16) T-10 or Auto	63-4	1	n/a
51-70C	Transmission Rear Yoke SEAL	63-7	1	9.75
51-70D	<b>Trans Rear Yoke (26 TOOTH FineSpline)(Muncie or 65-7 Auto (W U-bolts)</b>	63-70		\$135.00
51-71	<b>Drive Shaft 2" (with Correct U-joints/no Zerks)</b>	63-74	1	215.00
51-72	Drive Shaft U-bolts (2), Nut & Lw Set	63-7	2 PR	7.00 Pair
51-74	Rear Spring Anchor Plate	63-7	1	30.00
51-75	Rear Spring Anchor Bolts & Lw (4 Ea)(repl hmark)	63-7	1 SET	10.00 Set
51-76	Differential Cover (Heavy Duty)(use 65-7 Plug)	63-7	1	N/A
51-77A	<b>Differential Cover Gasket</b>	63-7	1	6.00
51-77B	Differential Cover Bolts & Lw (8 + 8) (O)	63-7	1 SET	8.00 Set
51-78A	Differential Cover Plug (Fine Thread)	63-4	1	18.50
51-78B	Differential Cover Plug (coarse thread)(NOS)	65-7	1	40.00
51-79	Gasket for Diff cover plug (cork/rubber)	63-7	1	1.75
51-80	Diff Plug Tag (see Sect 2-07)			
51-81	Limited Slip Diff. Additive (4 Oz)	63-7	1	14.95
51-82	Calipers (see Sect 52-31)			
51-84	Diff Ring Gear Inner Carrier Bearings	63-7	2	59.00 Each
51-85>	<b>Diff Bearing &amp; Seal Kit (2 #51-84, 2 51-88, 2 51-90, 1ea #51-93,94a,94b)</b>	63-79		345.00 Set
51-86	<b>Rear Spring Center Bolt W/nut</b>	63-7	1	6.50
51-87A	Diff Side Yoke & Deflector (327) (1)	63-7	2	120.00 Each
51-87B	Diff Side Yoke & Deflector (396/427) (1)	65-7	2	120.00 Each
51-87C	Yoke "c" Clips (pr)	63-7	1 PR	2.50 Pair
51-88	Seal- Diff Side Yoke (1)	63-7	2	20.00 Each
51-89	Deflector- Diff Side Yoke (1)	63-7	2	3.50 Each
51-90	Bearing- Diff Side Yoke (1)	63-7	2	32.00 Each
51-91A	Flange- Diff Front (63-4)	63-4	1	N/A
51-91B	Flange- Diff Front (65-7)	65-7	1	N/A
51-92A	Deflector- Diff Front Flange	63-7	1	12.00
51-92B	Diff Front Flange Spacer (crush Collar) (5/8long	63-6E	1	15.00
51-92C	Diff Front Flange Spacer (Long Crush Collar)	66L-7	1	20.00
51-92D	Diff Ring Gear Carrier Shims (5 Pc)	63-7	1 SET	20.00 Set
51-92E	Diff Front Flange Nut & Washer	63-7	1 SET	19.50 Set
51-92F	Diff Pinion Shim (10 Pc Set)	63-7	1 SET	15.00 Set
51-93	Seal- Diff Front Flange	63-7	1	15.00
51-94A	Outer Bearing- Diff Front Pinion	63-7	1	52.00
51-94B	Inner Bearing- Diff Front Pinion	63-7	1	59.00
51-96	<b>Differential Plastic Vent</b>	63-7	1	4.00
51-97A	Parking Brake Bolt (pr)	65-7	1 PR	4.50 Pair
51-97B	Parking Brake Bolt Locks (pr)	65-7	1 PR	3.50 Pair
51-98B	Posi Clutch Disk Pack (Eaton Rear)x no more (try chevy)	64-7	1	n/a
51-98D	Bolts & Lw For Ring Gear (10)	63-7	1 SET	10.00 Set
51-98E	Shim Kit For Posi Disks (3 Pc)	64-7	1 SET	28.00 Set
51-99	<b>Rear Spindle Greasing Tool</b>	63-7	1	25.00