

Section #24 Heater Hoses ● Expansion Tanks ● Pulleys ● Clamps

Sec-Part#	Name	Year	#Need/Car	Price	Inc
24-01C	Rad Supply Tank (PRESSED In Fittings)(give Date)	63-4E	1	175.00	
24-01A	Radiator Supply Tank (327/396/L88)	63-7	1	150.00	
24-01B	Radiator Supply Tank- Dated (give Date)	64L-7		175.00	
24-02A	Radiator Cap (ac 307-13 Lb)(63 All,64-5 no A/C,396)	63-5	1	35.00	
24-02B	Radiator Cap(rc 26-15 Lb)(66-7/327 All,64-5 A/C)	64L-7	1	35.00	
24-02C	Radiator Cap (rc 15-15 Lb)(427 All)	66-7	1	35.00	
24-03A	Supply Tank Straps (2 Long, 2 Short)	63	1 SET	17.00	SET
24-03B	Supply Tank Straps (PR)	64-7	1 PR	9.75	PAIR
24-04	Tank Strap Bolts With Correct EI Headmark (PR)	63-7	1 PR	2.50	PAIR
24-05A	Metal Brackets, Backing Plates & Rivets (set)	63	1 SET	15.00	SET
24-05B	Supply Tank Bracket	64-7	1	10.00	
24-05C	Fiberglass Supply Tank Support (use With 05a)	63	1	62.00	
24-06	Rivets (4 Pc)	64-7	1 SET	1.00	SET
24-07	Radiator To Supply Tank Hose (with Logo)	63-7	1	10.00	
24-08	Hose Clamps (for #24-07)(PR)	63-7	1 PR	12.00	PAIR
24-09	Overflow Hose (327/396/427)(ribbed)	63-7	1	5.00	
24-11	Hose Clamp (tank To T)(PR)	63-7	1 PR	2.50	PAIR
24-12	Heater Hose T Fitting	63-7	1	10.00	
24-14	3/4" Hose Clamp (PR)	63-7	1-2PR	1.50	PAIR
24-14A	Hose Clamp- 3/4" hose To Water Pump (with A/C)	66-7	1	1.50	EACH
24-15C	Heater Hose Set- 3/4 Ribbed, 5/8 With White GM	63-5	1 SET	35.00	SET
24-15D	Heater Hose Set- 3/4 Ribbed, 5/8 With White GM	66-7	1 SET	35.00	SET
24-16	5/8" Hose Clamps (PR)	63-7	1-2PR	1.50	PAIR
24-17	Hose Clip On Alternator Brace (with Twist)	63-5	1	10.00	
24-18	Bolt For Hose Clip #17	63-5	1	0.75	
24-19A	Heater Hose Straps- Aluminum (non A/C)(PR)	63	1 PR	5.00	PAIR
24-19B	Heater Hose Clips (non A/C)(PR)	64-7	1 PR	6.50	PAIR
24-21	Heater Hose Fittings (see Sect 21)				
24-25A	Hose Fender Clamp (427)(with Hardware)	65-7	1	10.50	
24-25B	Hose Fender Clamp (427 A/C)(with Hardware)	66-7	2	10.50	EACH
24-25C	Hose Fender Clamp (327 A/C)(with Hardware)	63-7	2	10.50	EACH
24-25D	Fender Clamp Bolts & Nuts (2 PR)(rbw)	63-7	1 SET	2.25	SET
24-25E	Hose Clamp On Fender Skirt (63-A/C)	63	1	5.50	
24-26A	Black 2-hole, Hose & Wire Plastic Strap	63-7	8	1.50	EACH
24-26B	White T-shaped, Hose & Wire Plastic Strap	63-4	7	1.50	EACH
24-26C	Black T-shaped, Hose & Wire Plastic Strap	65-7	7	1.50	EACH
24-26D	Complete Plastic Strap Set (8-2 Hole, 7-white T)	63-4	1 SET	16.00	SET
24-26E	Complete Plastic Strap Set (8-2 Hole, 7-black T)	65-7	1 SET	16.00	SET
> PLEASE LIST ALL OPTIONS WHEN ORDERING PULLEYS < ENTER CAR INFO ON CHECKOUT SCREEN					
24-27A	Upper Pulley (double)(250-300hp)(original)	63-5	1	126.00	USED
24-27B	Upper Pulley (double)(327/340,360,365-375hp)+ Upper Pulley (327/350hp)no P/S,no A/C	63-5	1	repro coming (\$120)	
24-27C	Upper Pulley (double)(327/250-300hp A/C)(orig) (65/350hp All)	64-5	1	108.00	USED
24-27D	Upper Pulley (double)(327/365hp)(A/C)	64-5	1	98.00	
24-27E	Upper Pulley (327/300hp)(66-7)single Groove	66-7	1	90.00	1
24-27F	Upper Pulley (double)327/300-350hp With A/C) + (350hp With P/S & A/C,350hp With P/S)	66-7	1	130.00	EACH
24-27G	Upper Pulley (double)(427)(no A/C)	67	1	109.00	
24-27H	Upper Pulley (double)(396/427)(no A/C)	65-6	1	132.00	
24-27J	Upper Pulley (triple)(427)(A/C)	66-7	1	212.00	
24-27K	Upper Pulley Reinforcement (327 Non A/C,427 A/C)	66-7	1	5.00	
24-28A	Lower Pulley (double)(327/250-300 Hp)	63-5	1	52.00	
24-28B	Lower Pulley (single)(327/300hp)(no A/C)n.o.s.	66-7	1	60.00	
24-28C	Lower Pulley (340,350,360,365,375hp)(double)	63-7	1	55.00	
24-28D	Lower Pulley (double)(327/250)(A/C)	63-5	1	52.00	
24-28E	Lower Pulley (double)(327/300-350hp)(A/C)replace	65-7	1	52.00	
24-28F	Lower Pulley (double)(327/300-350hp)(A/C) & No A/C 350hp	P/S 65-7	1	104.00	USED
24-28G	Lower Pulley (327 P/S)(except 350hp No A/C) (use With 28a,b,d,e,f)	63-7	1	53.00	
24-28H	Lower Pulley (double)(396/427 All)(cast Iron)nos	65-7	1	199.00	
24-28J	Lower Pulley (double)(327/365hp A/C)	64-5	1	55.00	
24-28K	Lower Pulley (327/350hp No P/S)	66-7	1	55.00	

New Repro: Fan blades with stampings: 63-64E = Round Head Rivets ; 64L-67 have flat head rivets -					
24-29A	Fan- Five Blade (17-1/8") (327 Except Ac)	64L-7	1	225.00	EACH
24-29B	Fan- Seven Blade (18") (64-65 327 With A/C)	64-5	1	250.00	EACH
24-29C	Fan- Five Blade (17.5"/more Pitch)(427)	66-7	1	225.00	EACH

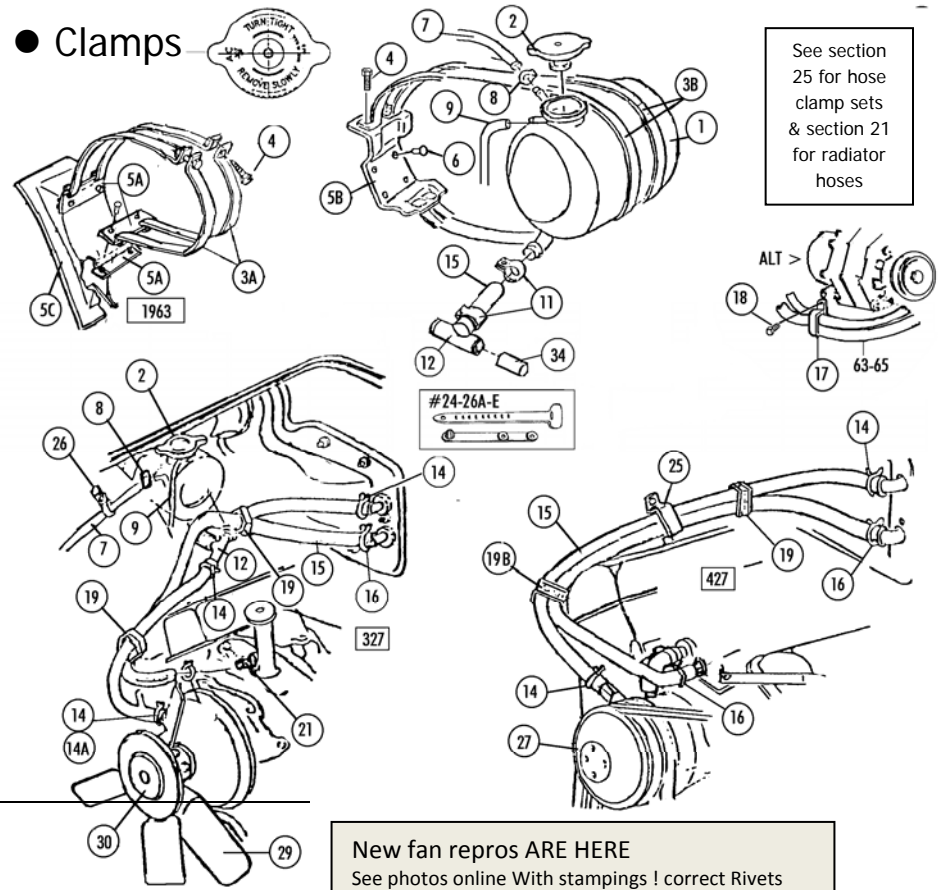

New Repro: Fan blades with stampings: 63-64E = Round Head Rivets ; 64L-67 have flat head rivets -					
24-29D	Fan- Five Blade (17"/more Pitch)(396)	65	1	225.00	EACH
24-29E	Fan- Five Blade (17-1/8") (327 No AC Roundhead Rivets)	63-4E	1	250.00	EACH
24-29ER	Fan-5 Blade (327 No Ac Rh Rivets) Wt On Blade	63-4E	1	175.00	EACH
24-29F	Fan- 5 Blade (18"more Pitch)(63 AC) roundhead Rivet	63-4E	1	250.00	EACH
24-29G	Fan- 5 Blade(18"more Pitch)(66-7 327 AC)Flathead Rivet	66-7	1	225.00	EACH
24-30	Fan Clutch- All (Coil Type) - GONE - use 24-30r	63-7	1	discontinued	
24-30A	Fan Clutch - 327 - (Bar Type) new repro next year?	63-7	1	n/a yet	
24-30B	Fan Clutch - 427 - (Bar Type) new repro next year?	66-7	1	n/a yet	
24-30R	Fan Clutch Eliminator (use Orig Fan With No Slip)	63-7	1	\$65.00	
24-31,33	Alternator Pulley (see Sect 23-02); 24-33 P/S Pulley (see Sect 23-27)				
24-34	Heater Delete Cap	63-7	1	5.00	
24-35A	Nut & Lw Set (fan To Clutch)(4 Ea)	63-7	1 SET	1.00	SET
24-35B	Bolt& Lw Set (fan Clutch To Water Pump)(4ea)(s)	63-7	1 SET	7.00	SET
24-35C	Stud (fan To Fan Clutch)(4 Pc)	63-7	1 SET	5.00	SET
24-36A	Bolt & Lw Set (lower Pulley-327)(3 Ea) (e Hdmdk)	63-7	1 SET	6.50	SET
24-36B	Bolt & Lw Set (lower Pulley- 396/427)(3 Ea) (tr)	65-7	1 SET	2.25	SET
24-37A	Harmonic Balancer(327)(250-300 Hp) , Rebuilt	63-5	1	190.00	EACH
24-37B	Harmonic Balancer (327)(300hp)(nos)	66-7	1	130.00	
24-37C	Harmonic Balancer (327 Hiper)(replacement)see37g	63-7	1	N/A	
24-37D	Harmonic Balancer (427)(390-400hp)	66-7	1	160.00	
24-37E	Harmonic Balancer (396/427)(425-435 Hp)	65-7	1	195.00	
24-37F	Harmonic Balancer (188) (nos)	67	1	N/A	
24-37G	Harmonic Balancer (327 Hiper)(finned)	63-7	1	360.00	
24-37Y	Balancer Saver(repairs Groove From Seal-327)	63-7	1	14.00	
24-37Z	Balancer Saver(repairs Groove From Seal-396/427)	65-7	1	14.00	
24-38A	Harmonic Balancer Bolt, Lw & Spacer (327)(hiper)	63-7	1	8.50	
24-38B	Harmonic Balancer Bolt, Lw & Spacer (396/427)	65-7	1	6.00	
24-38C	Woodruff Key For Crankshaft-balancer+timing Gear	63-7	1	3.00	