

## Section #23 Alternator Mounting & Power Steering Pump & Mounting

Sec- Part#	Name	Year #/Car	Price Inc
23-01	Alternator	63-7	1 N/A
23-02A	Alternator Pulley (250-350HP No A/C)with Or Without P/S	63-5	1 36.50
23-02B	Alternator Pulley & Disk (250-300HP A/C)	63	1 SET 75.00SET
23-02C	Alternator Pulley (250-300HP A/C)	64-5	1 36.50
23-02D	Alternator Pulley (390-400HP A/C & P/S)	66-7	1 36.50
23-02E	Alternator Pulley (390-400HP A/C No P/S)	66-7	1 36.50
	(66-7/350HP A/C)	66-7	
23-02F	Alternator Pulley (390-435HP No P/S No A/C,365HP A/C)	64-7	1 36.50
	66-7 327/350HP No P/S, No A/C	66-7	
23-02G	Alternator Pulley (340,360-375HP No A/C)	63-5	1 36.50
23-02H	Alternator Pulley (390-435HP P/S No A/C)	65-7	1 36.50
23-02J	Alternator Pulley & Fan(300HP No A/C,350HPno P/S No Ac)	66	1 50.00
23-02K	Alternator Pulley & Fan (65 250-350 A/C,66 300HP A/C)	65-6	1 N/A
	(66-7/350HP P/S No A/C)(use 23-02L)	66-7	
23-02L	Alternator Pulley & Fan(300HP No A/C,350HPno P/S No Ac)	67	1 50.00
23-02M	Alternator Pulley & Fan (300HP A/C)	67	1 50.00
23-03A	Alternator Fan	63	1 25.00
23-03B	Alternator Fan	64-7	1 25.00
23-03C	Alternator Pulley Nut & Washer	63-7	1 5.00
23-03D	Internal Spacer For Alternator Fan	63-7	1 3.00
23-04A	Alternator Bracket- RH (327)	63-5	1 36.00
23-04B	Alternator Bracket- LH (327 A/C)	63	1 50.00
23-04C	Alternator Bracket- LH (327)	64-7	1 28.00
23-04D	Alternator Bracket- LH (427)	66-7	1 89.00
23-04E	Alternator Bracket- P/S LH (396/427)	65-7	1 50.00
23-04F	Alternator Bracket- LH (396) (exact Repro)	65	1 105.00
23-05A	Alt Long Bolt, Washer, Nut (for 4a,b,d,f) (tr)	63-7	1 4.50
23-05B	Alt Long Bolt And Lw (for 4c) (O)	64-7	1 1.25
23-05C	Alt Long Bolt, Washer & Nut (for 4E)	65-7	1 1.50
23-06	Alternator Spacer (63-5 327 & 65-7 396/427) (nos)	63-7	1 3.50
23-07A	Alt Bracket Bolts & Washers (63-65 RH)(pr)	63-5	1 PR 2.00PAIR
23-07B	Alt Bracket Bolts & Washers (63 LH-A/C)(pr)	63	1 PR 3.00PAIR
23-08	Bolt & Washer (396/427 P/S) (1 Each) (O)	65-7	1 1.00
23-09	Bolt & Washer (396/427 P/S) (tr Hdmk)	65-7	1 2.00
23-10	Bolts & Washers (396/427 P/S)(3 + 3)	65-7	1 SET 2.25SET
23-11	Bolts & Washers (tr)(396/427 No P/S)(3+3)	65-7	1 SET 4.50SET
23-12	Stud & Nut (396/427 P/S)	65-7	1 5.50
23-13A	Alt Brace RH 327	64-5	1 20.00
23-13B	Alt Brace LH A/C	63	1 20.00
23-13C	Alt Brace LH 327 (correct- No Extra Hole)	66-7	1 20.00
	& 64-65 350-365 HP With A/C (correct Repro With No Extra Hole)		
23-13D	Alt Brace LH 396/427	65-7	1 20.00
23-13E	Alt Brace LH 396/427 P/S	65-7	1 10.00
23-13F	Alt Brace LH 327/250-300HP With A/C	64-5	1 30.00
23-13G	Alternator Brace (RH)(with V Stamping)	63	1 25.00
23-14	Top Bolt, Washer & Spacer (wb Hdmk)	63-7	1 1.25
23-15A	Alt Brace Bolt & Lw (RH)(tr)(water Pump)	63-5	1 2.00
23-15B	Bolt & Lw- LH Alt Brace To Water Pump(tr)(327)	64-7	1 3.00
23-15C	Alt Bracket Bolt & Lw (327 LH)(exh)	64-7	1 1.00
23-15D	Alt Brace Bolt & Lw (396/427)(no P/S)	65-7	1 1.50
23-16	Alt Brace LH (396/427 P/S)	65-7	1 12.00
23-17	Brace P/S Pump & Alt. (396/427)	65-7	1 63.00
23-18	Bracket Power Steering Pump (396/427)	65-7	1 48.00
23-19B	Power Steering Pump Bracket (327)(thru11/64=65e)	63-5E	1 24.00
23-19C	Power Steering Pump Bracket (327)	65L-7	1 24.00
23-19D	Power Steering Pump Brace (327)	63-7	1 20.00
23-21A	P/S Bracket Bolt & Lw (327)(9 Pc Set)	63-5E	1 SET 3.00SET
23-21B	P/S Bracket Bolts & Lws (327)(9 Pc Set)	65L-7	1 SET 3.00SET
23-22	Power Steering Pump Belt Guard (327- A/C)	65-7	1 18.00
23-23	Belt Guard Bolts (pr) (327 A/C)	65-7	1 PR 1.50PR
	<b>P/S Pump Pulleys - --- See Section 24 For Upper And Lower Pulleys...</b>		
23-24B	P/S Pump- Rebuilt(327/396/427)(with New Case)	63-7	1 250.00
23-24C	P/S Pump Metal Case (with All Seals To Change)	63-7	1 99.00
23-24D	P/S Pump Filler Cap (round Plastic Replacement)	63-7	1 4.00
23-24E	Power Steering Metal Cap- With Ears & Writing	63-7	1 50.00

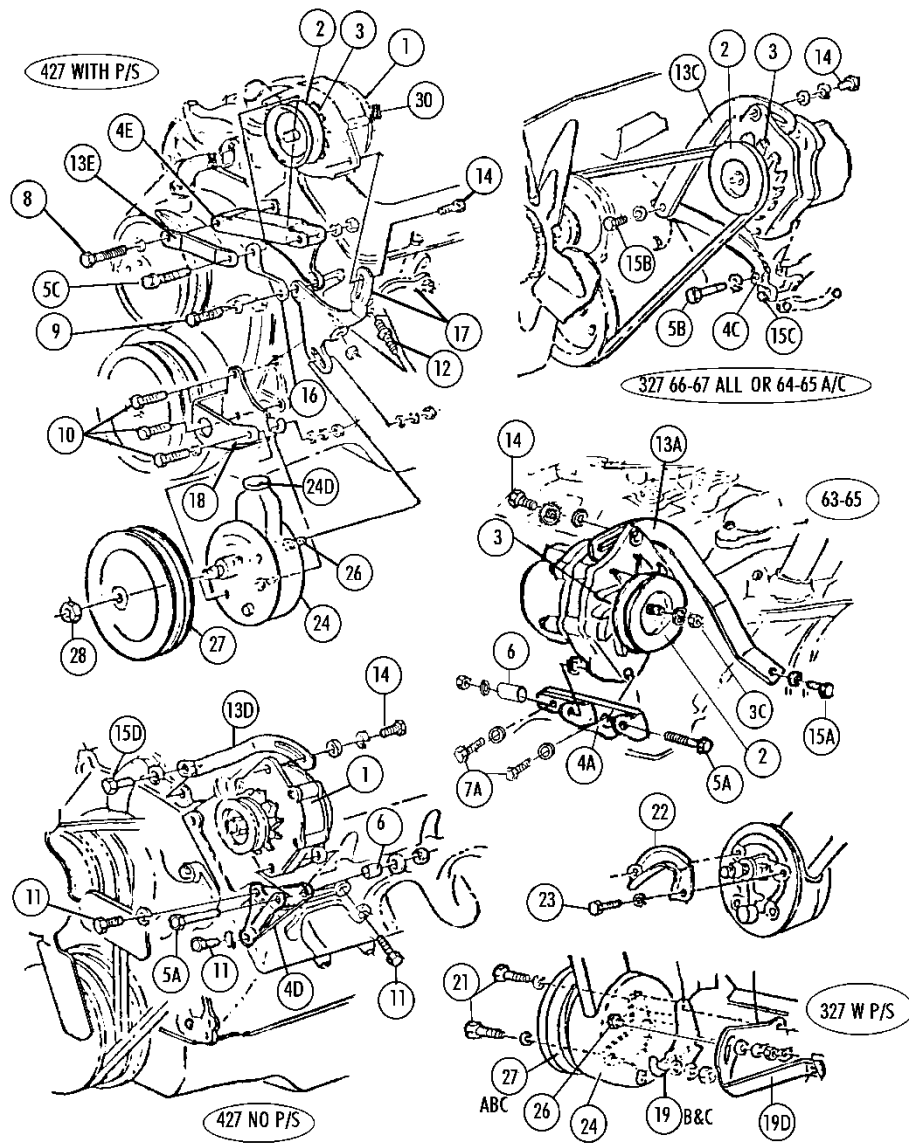

Sec- Part#	Name	Year #/Car	Price Inc
23-25	P/S Pump Seal Kit (7 Pc)	63-7	1 SET 17.00SET
23-26	P/S Pump Stud, Nut & Washers	63-7	1 SET 4.00SET
23-27A	Single Pulley (250-300HP All)(350HP A/C)	63-7	1 62.00
23-27B	Single P/S Pulley (327/350 HP No A/C)(cast Iron)	65-7	1 97.00
23-27C	Double P/S Pulley (396/427)(cast Iron)	65-7	1 108.00
23-28	P/S Pulley Nut	63-7	1 2.00
23-28B	P/S Pulley Woodruff Key	63-7	1 1.00
23-29	Idler Pulleys (see Section 21 #28-31)		
23-30A	Alternator Plug	63-7	1 6.00
23-30B	Alternator Terminal Nut & Lw Set	63-7	1 SET 0.75SET
23-30C	Alternator Boot (correct With + Raised Rib)	63-7	1 10.00
23-31	396/427 P/S Bracket Set (4e,13e,16,17,18)	65-7	1 SET 160.00SET
23-32	396/427 P/S+Alt Bolt Set(5c,8,9,10,12,14,26)	65-7	1 SET 15.00SET
23-33	Capacitor In Alternator With Retainer	63-7	1 20.00EACH

(See Section 41 For More Power Steering, Section 24 for other pulleys)  
 - See photos online [www.licorvette.com](http://www.licorvette.com) -